



  
**PRICELESS**  
— SINCE 1998 —

## MEDIA KIT - EVENTS

**PRICELESS**  
— EVENTS —



## SURREY HOMES MAGAZINE IS OPENING IT'S DOORS...

Since Surrey Homes magazine was launched 4 years ago, our exhibitors, advertisers and visitors have all been asking us to bring the Wealden Fairs' magic to the lovely county of Surrey. We have always loved the idea, but first, we had to create an event and find the right venue!

We are delighted to announce that Open House, a fabulous shopping extravaganza celebrating gorgeous interiors, food and fashion, will take place at Sandown Park in Esher on 10, 11, 12, October 2019. Open House will be an indoor, shell-schemed event sprinkled with the PRICELESS fairy dust that has made the Wealden Fairs so successful. We're thrilled to be at Sandown Park, a fantastic location in the heart of leafy Surrey but within the M25 and with easy access to a London audience as well as many counties further afield.

We're looking forward to introducing skilled artisans, designers and independent businesses to the affluent and discerning householders of Surrey.

---

*Launching 10th, 11th & 12th October 2019 | 9.00am - 4.30pm | Sandown Park, Esher KT10 9AJ*

**Stand** - £175 per sqm

**Included in your stand price-**

- Shell scheme
- 500w power point
- Row of 2 spotlights
- Access to exhibitor lounge
- Stand cleaning
- Exhibitor parking
- 10x complimentary tickets
- Listing on the website and in the show guide

**Contact** - Jude Brown  
jude.brown@priceless-group.com  
01580 236071

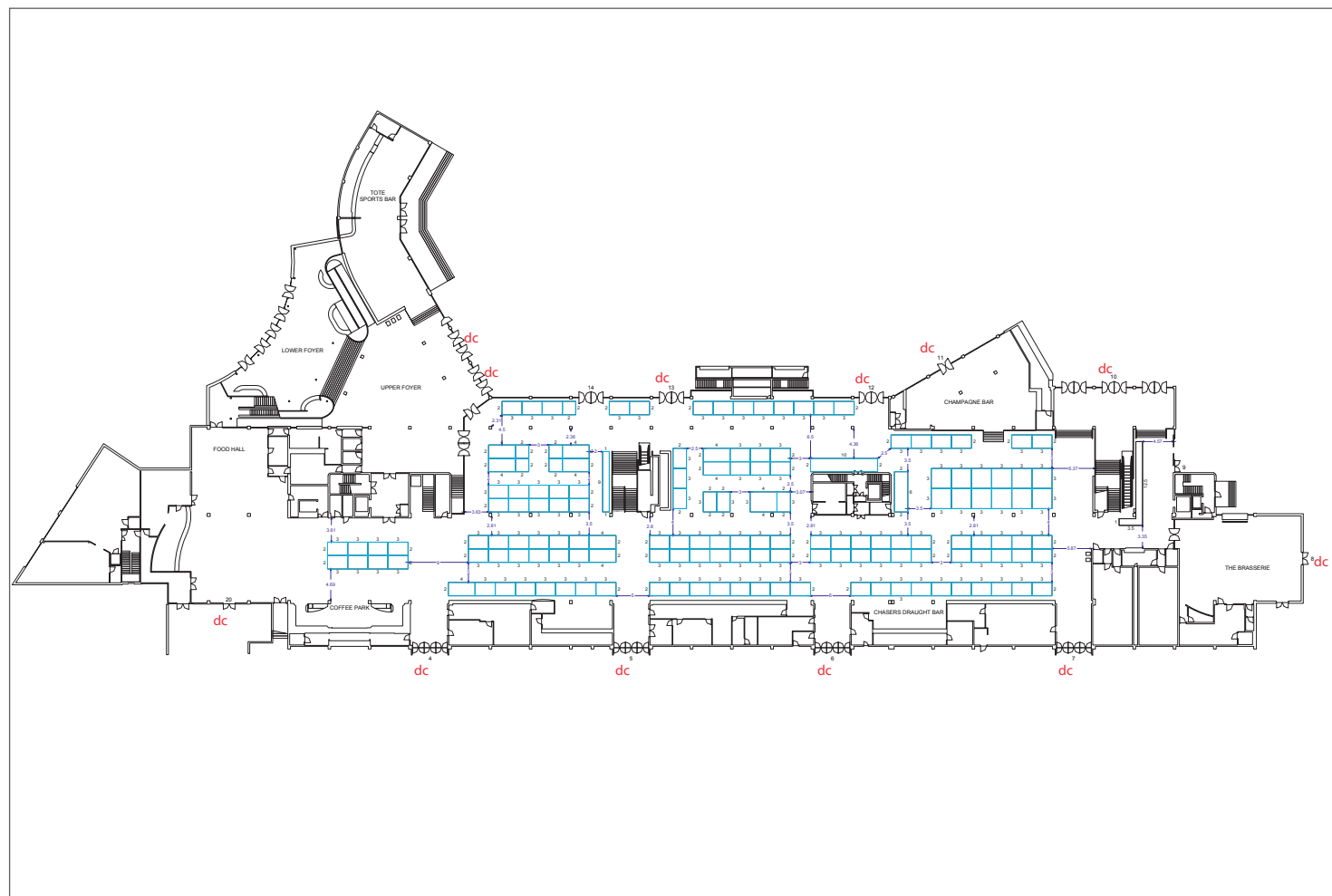

*6,000 visitors* | *Launching 10th, 11th & 12th October 2019* | *Sandown Park, Esher KT10 9AJ*

## Marketing

Promotion in Surrey Homes magazine every month from March onwards (15,000 print run)

35,000 show guides distributed within Surrey Homes and through direct door drops in the local area

Train station poster advertising

Banners and outdoor signage throughout the local area

Inclusions on Sandown Park Racecourse what's on website, leaflets and in emails to database

Leaflets distributed in local area

Social media and website advertising

Contacts with local business and schools



*6,000 visitors* | *Launching 10th, 11th & 12th October 2019* | *Sandown Park, Esher KT10 9AJ*



*media@priceless-group.com*

*events@priceless-group.com*

PRICELESS  
— MEDIA —



PRICELESS  
— EVENTS —